

**G55JCS12XX** Series Stainless Steel

23" Stainless steel folding grab bar. 1.25" diameter, 1.2mm wall thickness, 304 stainless steel.

Mounting hardware not supplied.

**Product Data**

Overall Dimensions (Inch.)	41-15/16 x 23-5/8 x 8-11/16
Net Weight (lbs.)	4.3

**Packaging Details**

Package	Cardboard package
Package dimensions (Inch.)	25-3/8 x 10-5/8 x 5-1/8
Weight with Packaging (lbs.)	5.35

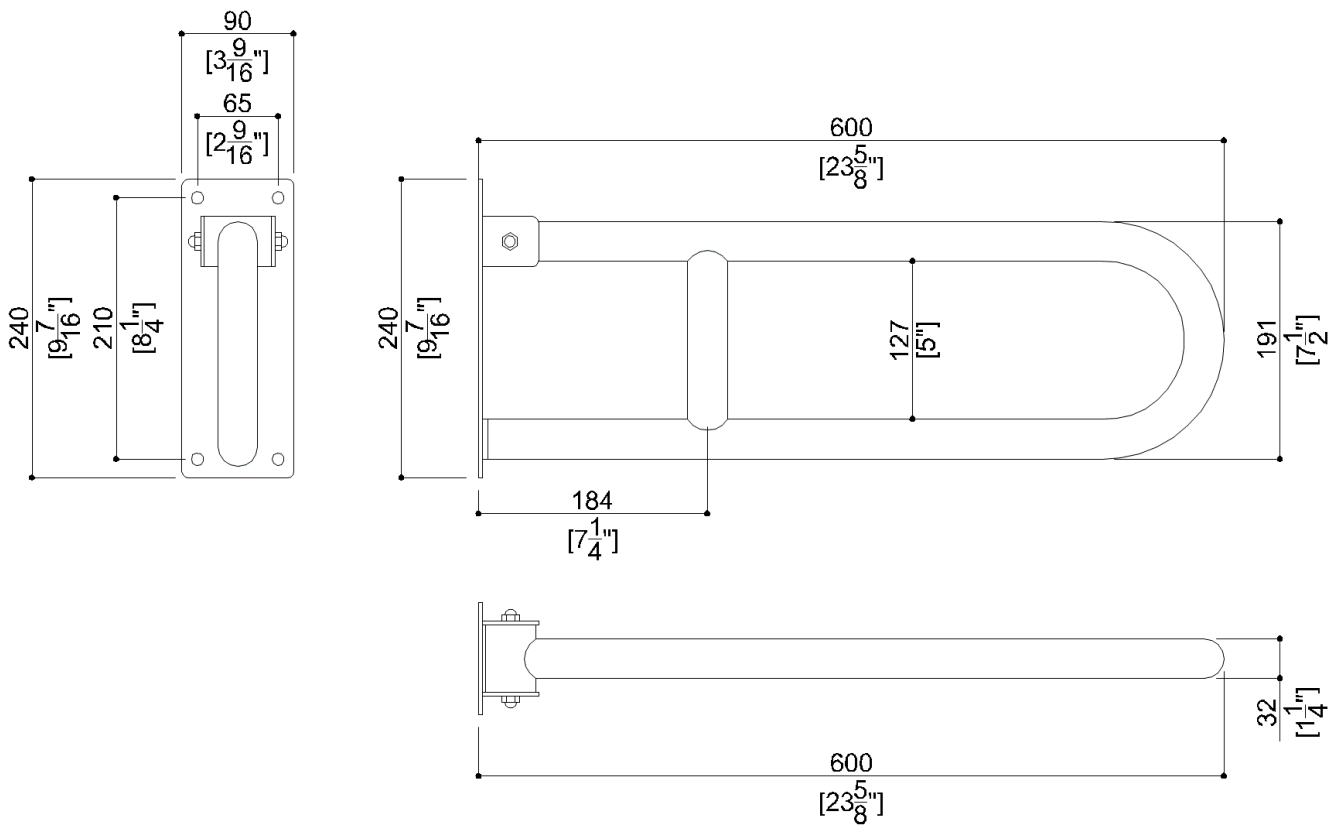
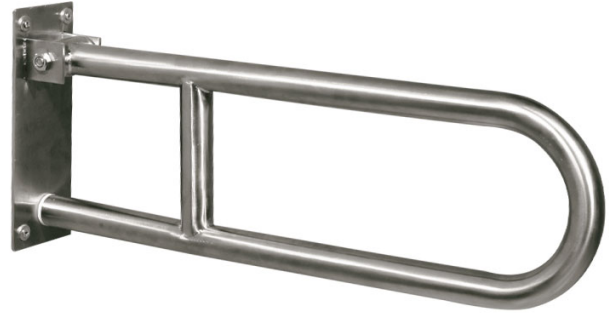

**G55JCS12XX** Series Stainless Steel

AISI304 stainless steel fixing plate

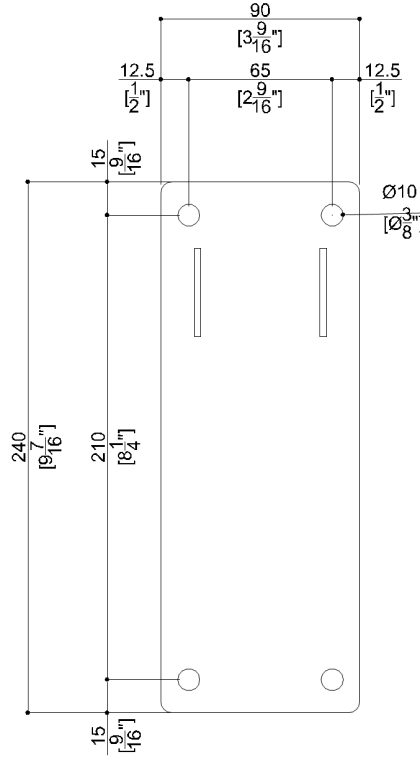

**Available Finishes (xx)**

- N1  Satin

**Materials and finishes**

Stainless Steel                      Satin

**Load Capacity**

Vertical	331 lbs.	Horizontal	88 lbs.
----------	----------	------------	---------

**Warning**

Before installation and use, read the installation and use instructions in their entirety. If questions arise please contact Ponte Giulio company.

**Cleaning**

Product can be cleaned with a cloth and warm soapy water. Non abrasive, solvent free cleaners can also be used.

**Warranty**

Please visit [www.pontegiulio.com](http://www.pontegiulio.com) for complete warranty details.