

Flanges for 1" diameter [Ø25] Shower Curtain Rod, End Flanges (pair)

Shower/Tub Accessories

MasterFormat Section 10 28 13

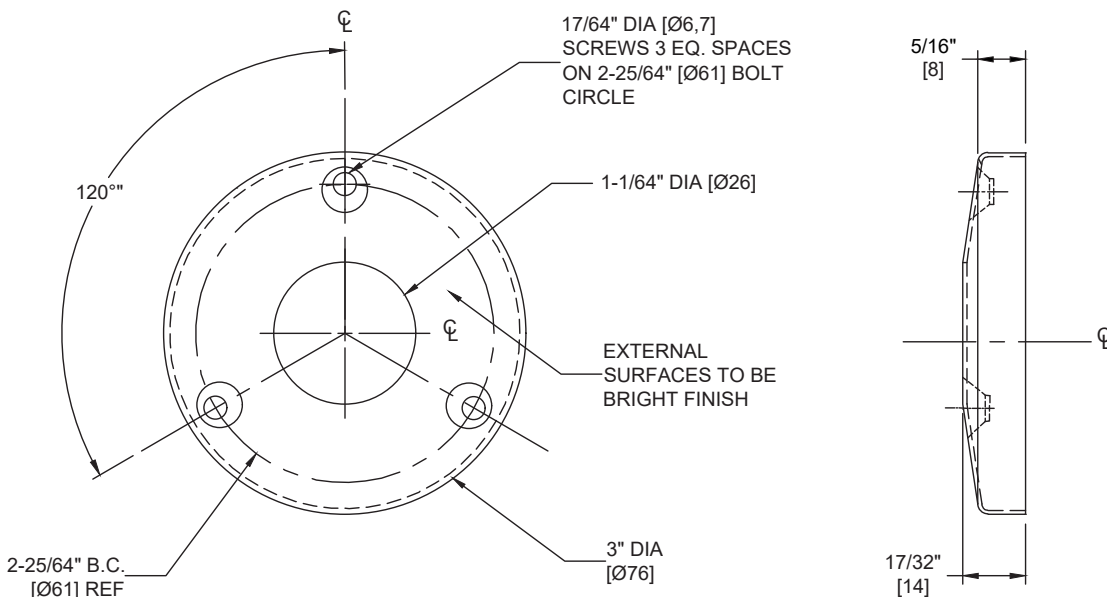

Scan for Information



SUSTAINABILITY/LEED

MR 4.1 (1) MR 6 (1) EQ 4.2 (1)
MR 4.2 (1) EQ 4.1 (1) EQ 4.4 (1)

NOTE:
ALL DIM'S INCH [MM]
ILLUSTRATION FOR REF ONLY AND NTS

PRODUCT OVERVIEW

Flanges are fabricated of type 304 stainless steel alloy 18-8. Flanges have three (3) dimpled 17/64" diameter [Ø7] holes to accept either 1/4 [M6] or #10 [M5] oval head screws (provided by others). Flanges only.

KEY FEATURES & SPECIFICATIONS

- Designed to accept 1" Dia. [Ø25] rod
- Type 304 Stainless Steel - Bright Finish
- 20 gauge Thick Material
- Surface Mounted

**Model #1214-1****Technical Data Sheet****OPERATION & MAINTENANCE**

Rod is held captive by flanges when installed properly. Rod may rotate in flanges if turned by hand. Correctly installed rod and flanges will support specified shower curtain(s) hung on hooks 1200-SHU or others (by others). Rod will bend and pull from flanges if significant body weight is suspended.

TECHNICAL INFORMATION / PRODUCT PROPERTIES

Property	Value
Dimensions	3" [Ø76] Diameter flange x 1" Dia. Rod [Ø25] x 17/32" [13]
Construction	Type 304 Stainless Steel - Bright Finish 20 gauge Thick Material
Mounting	Surface Mounted
Materials	<u>20 gauge (.0356" [0.9] thick) type 304 stainless steel. Exposed surfaces are satin finish. Edges and corners are radiused and burr free.</u>

INSTALLATION

Install rod in straight section between two (2) mounting flanges with no more than 1/4" [6] total wall clearance. Rods longer than 72" [1829] require ceiling hanger Model #1224-C18. For use with standard shower curtain Model #1200 or #1200-V having 72" [1829] length and standard hooks (Model #1200-SHU) install unit with rod centerline 74-1/2" [1892] maximum above finished floor (MAX AFF) or 67" [1702] above tub rim to obtain 6" [152] bottom overlap. Seal screw holes in walls under flange to prevent any sprayed water from possibly infiltrating the wall structure.

ADDITIONAL INFORMATION**WARRANTY**

One (1) Year from date of Invoice