

RECESSED HAND DRIER

Specifications and Dimensions

Model	Volts	Watts	Amps	Housing Dimensions: mm (in)		
				W	H	D
2200SA(R)	110-120Vac	1848-2200W	16.8-18.3A	340mm(13-25/64")	361mm(14-7/32")	156mm(6-9/64")
	220-240Vac	1848-2200W	8.4-9.2A			

Recessed Box Diagrams:

Rough wall opening: 325*347*158 mm
(12-51/64*13-21/32*6-7/32 in).

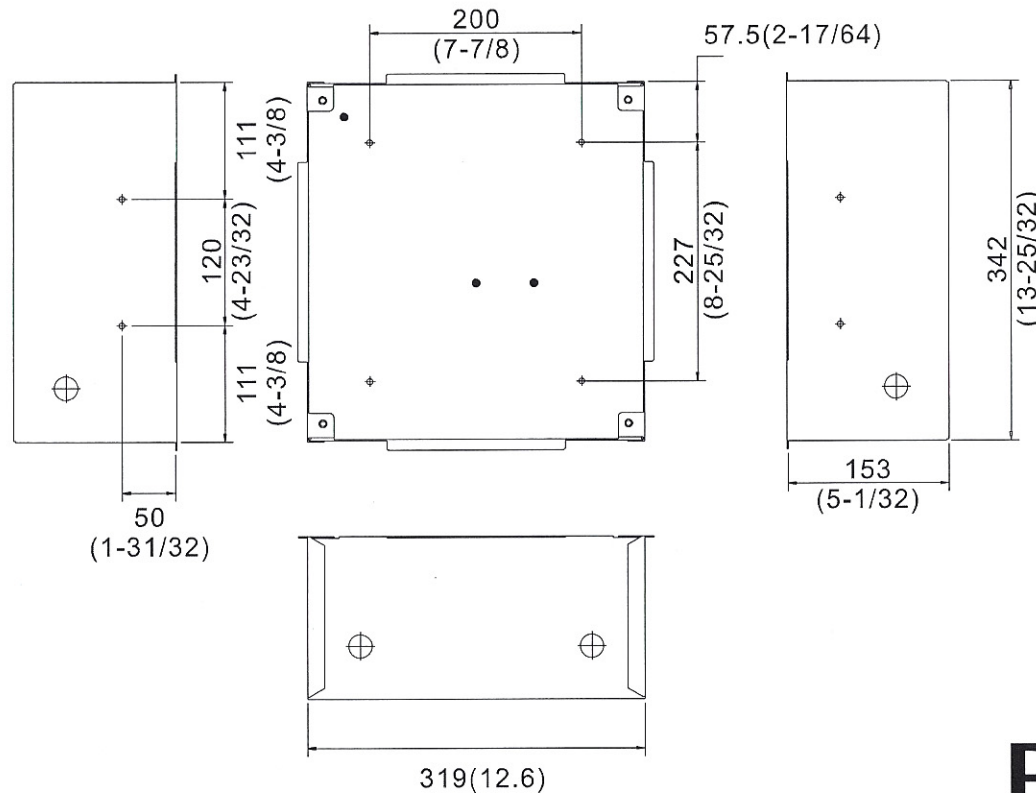
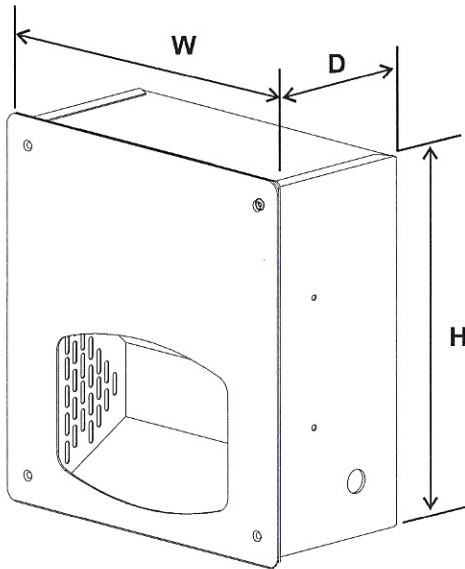
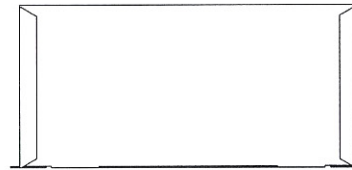

Installation:

Rough wall opening: 325*347*158 mm (12-51/64*13-21/32*6-7/32 in)

- 1.** Remove the front plate from the recessed box.

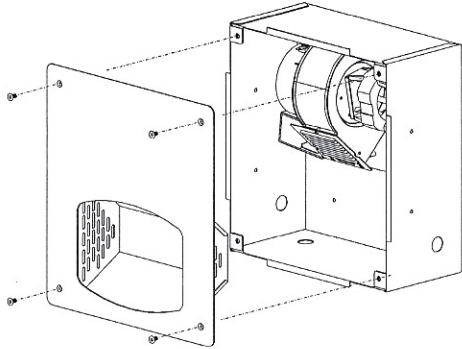

- 2.** Remove the main unit from the recessed box.

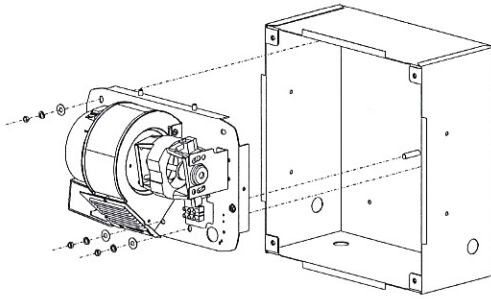

- 3.** Insert the bushing into the side hole of the recessed box. Insert the recessed box into the wall and fix it.

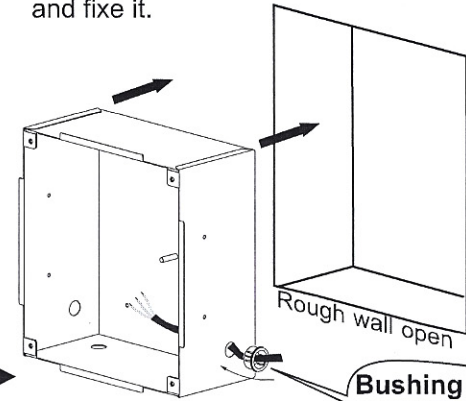

- 6.** Attach the front plate back to the recessed box.

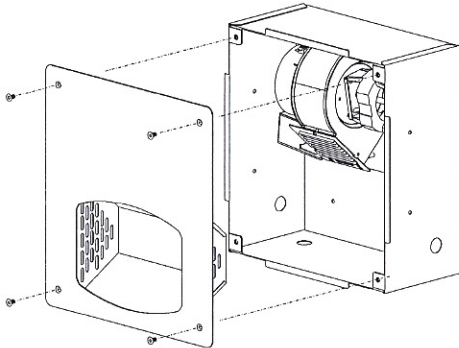

- 5.** The wire connections are as follows :

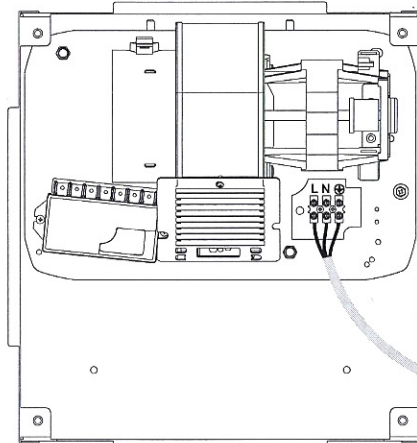

- 4.** Attach the main unit back to the recessed box.

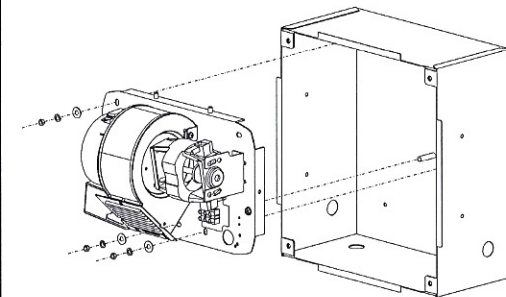

Connections:

- A. Connect the live wire (colored red or brown) to the terminal block marked "L".
- B. Connect the neutral wire (colored black or blue) to the terminal block marked "N".
- C. Connect the ground wire (colored green and yellow) to the green screw marked "⊕".

FASTDRY