



AMERICAN SPECIALTIES, INC.

441 Saw Mill River Road, Yonkers, NY 10701 (914) 476-9000

MODEL No: 8425

ISSUED:

REVISED: 9-96

SURFACE MOUNTED CLOTHES HOOK

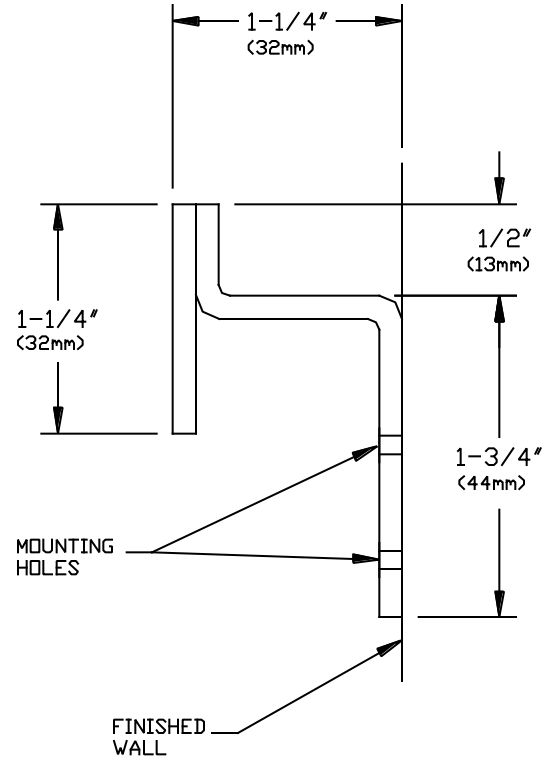
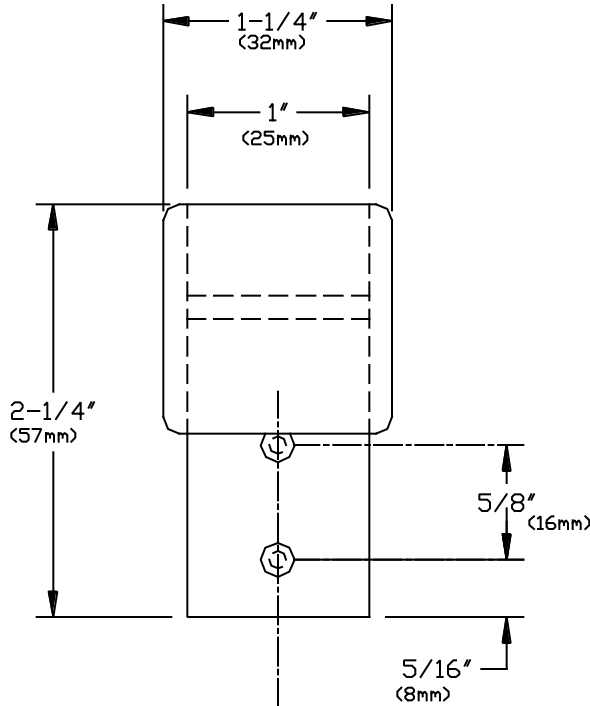

SPECIFICATION

Surface Mounted Clothes Hook shall be fabricated of alloy 18-8 stainless steel, type 304. Hook shall be formed from one piece of N^o11 gauge stainless steel and shall project 1-1/4" (32mm) from mounting surface with a 1/2" (13mm) hook tip. A 1-1/4" (32mm) square stainless steel safety dress plate with radiused corners shall be aligned and welded to hook tip. Two (2) 7/32" (5.6mm) dia. holes shall be provided to accommodate mounting screws. All exposed surfaces shall be N^o4 satin finish.

Surface Mounted Clothes Hook shall be Model N^o 8425 as fabricated by American Specialties, Inc., 441 Saw Mill River Road, Yonkers, New York 10701- 4913

INSTALLATION

Unit is surfaced mounted to wall or partition using N^o10 self tapping screws (supplied) through two (2) mounting holes provided. For compliance with ADA Accessibility Guidelines, unit should be installed 54" (1372mm) maximum above finished floor (AFF) if clear floor side reach access is provided or 48" (1219mm) max. AFF if clear floor forward reach access is provided.

Accessory Specialties

AMERICAN DISPENSER

Desert Ray Products

WATROUS INC.

THIS MANUFACTURER RESERVES THE RIGHT TO MAKE CHANGES IN DESIGN OR DIMENSIONS WITHOUT FORMAL NOTICE