

**ROVAL™ Surface Mounted Waste Receptacle**

Waste Receptacles	Roval
-------------------	-------

MasterFormat Section 10 28 13

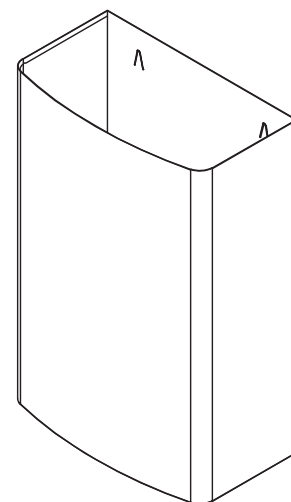
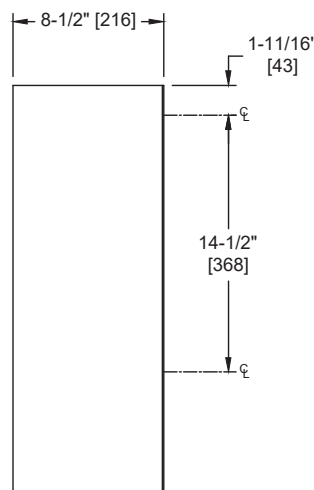
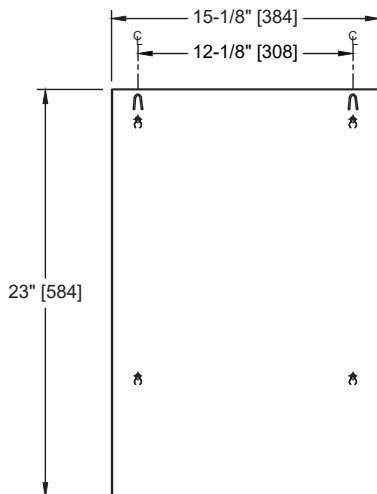
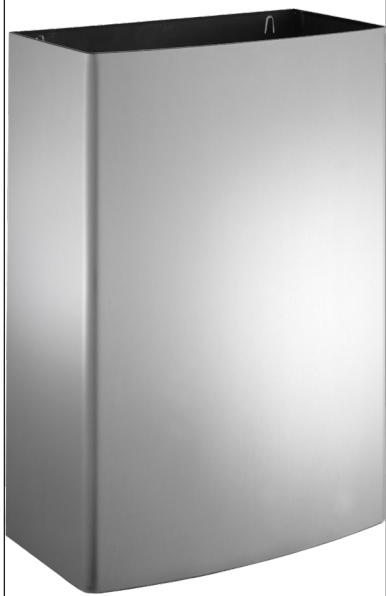

Scan for Information



**SUSTAINABILITY/LEED**

MR 4.1 (1) MR 6 (1) EQ 4.2 (1)  
MR 4.2 (1) EQ 4.1 (1) EQ 4.4 (1)

**NOTE:**  
ALL DIM'S INCH [MM]  
ILLUSTRATION FOR REF ONLY AND NTS

**PRODUCT OVERVIEW**

Receptacle front and sides fabricated of 20 gauge type 304 stainless steel with satin finish. Capacity 12.8 gal. (48.4 L). Receptacle includes four (4) interior hooks for hanging a reusable heavy gauge vinyl liner bag with grommets (by others). Receptacle is screw mounted to wall through keyhole slots with concealed heavy gauge type 304 stainless steel reinforcement straps. User deposits waste material. Unload unit by removing either the disposable bag or reusable liner bag (both by others) to empty into appropriate bulk collection container.

**KEY FEATURES & SPECIFICATIONS**

- Curved front adds strength and elegance
- Type 304 Stainless Steel - Satin Finish
- Surface Mounted
- 12.8 Gal. (48.4 L) Waste Capacity

**Model #20826****Technical Data Sheet****OPERATION & MAINTENANCE**

User deposits waste material. Maintenance schedule determines trash removal cycle. Unload unit by removing either the disposable bag or reusable liner bag (both by others) to empty into appropriate bulk collection container.

**TECHNICAL INFORMATION / PRODUCT PROPERTIES**

Property	Value
Dimensions	15-1/8" [384] W x 23" [584] H x 8-1/2" [216] D
Construction	Type 304 Stainless Steel - Satin Finish
Mounting	Surface Mounted
Capacity	12.8 Gal. (48.4 L) Waste Capacity

**INSTALLATION**

For general utility mount the receptacle 28" [711] to 40" [1016] Above Finished Floor (AFF) from top of unit. Hang unit on wall with four (4) pre-installed screws (by others) through the mounting keyhole slots provided into suitable wall reinforcements (by others).

**OPTIONS**

N/A

**WARRANTY**

One (1) Year from date of Invoice