



American Specialties, Inc.

Model #0751-A

Technical Data Sheet

Robe Hook (Heavy-Duty) – Surface Mounted (Exposed), Satin Chrome Plated Brass

Specialty Accessories

MasterFormat Section 10 28 13



Scan for
Information



SUSTAINABILITY/LEED

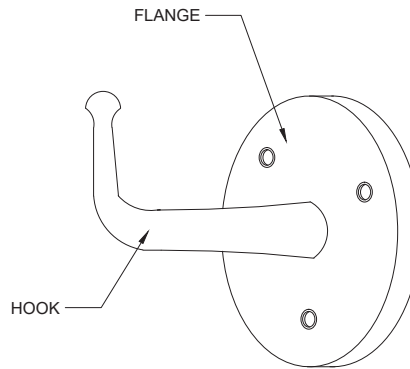
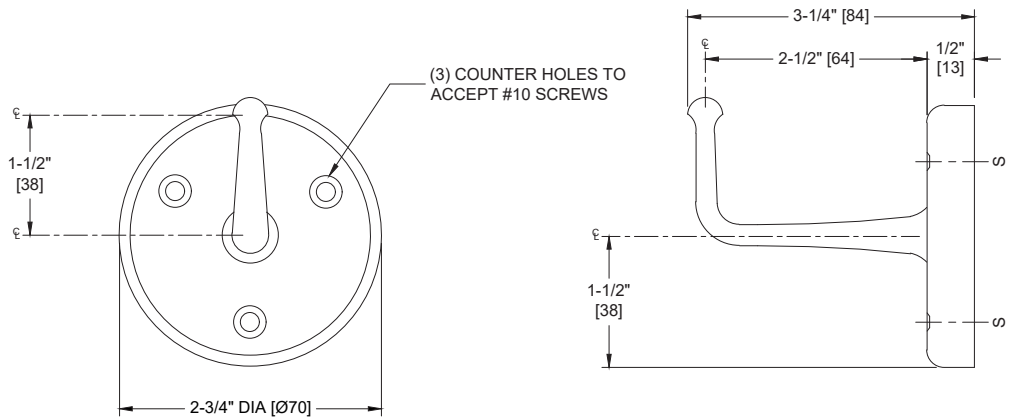

NOTE:
ALL DIM'S INCH [MM]
ILLUSTRATION FOR REF ONLY AND NTS

PRODUCT OVERVIEW

Fabricated of brass with a chrome finish. Exposed mounting. Three (3) 7/32" diameter [6 diameter] countersunk holes provided for anchoring hook to wall on 2-3/4" [70] diameter flange. Hook is capable of supporting over 181 lbs [82 kg] when properly attached to building element.

KEY FEATURES & SPECIFICATIONS

- (Exposed), Satin Chrome Plated Brass
- Heavy Duty Chrome Plated Brass - Chrome Finish
- Surface Mounted

**American Specialties, Inc.****Model #0751-A****Technical Data Sheet****OPERATION & MAINTENANCE**

Washroom accessory products require regular surface cleaning, much the same as stainless steel sinks, pots and pans, and eating utensils. As long as a regular cleaning schedule is followed, the best method is cleaning with a soft clean rag moistened with a mild detergent, followed by a water-moistened clean rag and then a dry rag.

TECHNICAL INFORMATION / PRODUCT PROPERTIES

Property	Value
Dimensions	2-3/4" [70] x 2-3/4" [70] x 3-1/4" [83] Projection
Construction	Heavy Duty Chrome Plated Brass - Satin Finish
Mounting	Surface Mounted
Capacity	Hook is capable of supporting over 181 lbs [82 kg] when property attached to building element.

INSTALLATION

Unit is surface mounted on wall or partition using stainless steel Philips flat or oval head #10 self-threading screws (provided by others to suit wall conditions) in a manner capable of supporting 181 lbs (82 kg). Ensure that mounting configuration complies with local building codes. For compliance with 2010 ADA Accessibility Standards install the hook center-line 54" [1372] maximum Above Finished Floor (AFF) when clear floor side reach access is provided or 48" [1219] max AFF with clear floor forward reach access only provided.

ADDITIONAL INFORMATION

N/A

WARRANTY

One (1) Year from date of Invoice